

SCELTA DEL MODELLO DI ADATTATORI

Per l'installazione del CMT800 è necessario il supporto placca 3 moduli della serie elettrica utilizzata. Su ogni adattatore è stampato il nome della serie elettrica. Scegliere la coppia di adattatori corrispondente alla serie elettrica utilizzata.

ESEMPIO *Serie elettrica* **VIMAR PLANA**
 Supporto placca **VIMAR PLANA**
 Adattatori **VIMAR PLANA**

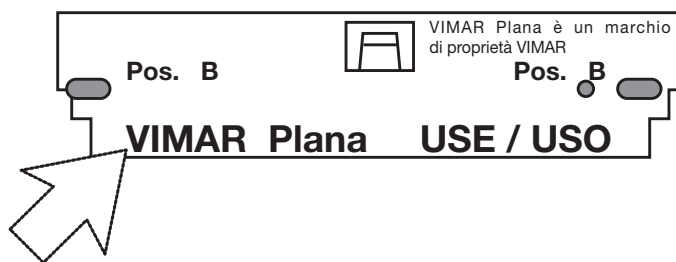

MONTAGGIO DEGLI ADATTATORI

1
Prendere la coppia di adattatori della serie elettrica in uso. Leggere la lettera (in questo esempio la B) che indica la posizione di inserimento dei centratori (R) e (L).



2
Prendere il CMT800 e allineare l'adattatore in modo che i centratori siano in corrispondenza dei fori indicati dalla lettera (in questo esempio la B).

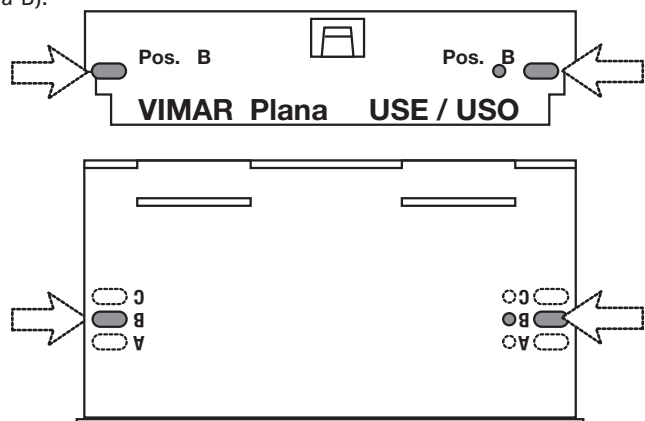

3
Ribaltare l'adattatore e inserire i centratori nel CMT800. Ripetere l'operazione sull'altro lato del CMT800.

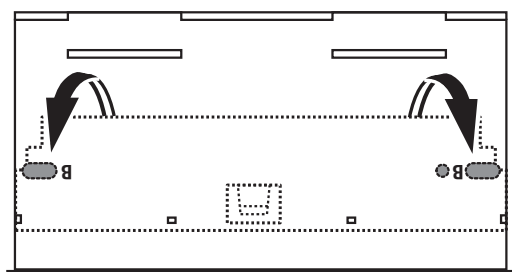

4
Inserire il CMT800 con gli adattatori nel supporto placca 3 moduli della serie elettrica utilizzata e completare l'installazione.

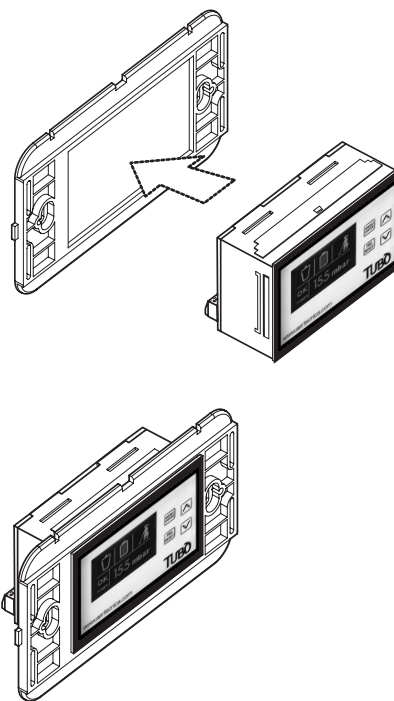

PLACCHE ELETTRICHE COMPATIBILI

BTICINO	Axolute
BTICINO	Living
BTICINO	Light
VIMAR	Idea
VIMAR	Plana
VIMAR	Eikon
GEWISS	Chorus Lux
GEWISS	Chorus One
GEWISS	Chorus Art

SELECTING THE ADAPTOR MODEL

CMT800 installation requires the 3 module switch plate support that corresponds to the utilised electrical series. The name of the electrical series is printed on each adaptor. Select a pair of adaptors that corresponds to the utilised electrical series.

EXAMPLE *Electrical series* **VIMAR PLANA**
 Switch plate support **VIMAR PLANA**
 Adaptors **VIMAR PLANA**

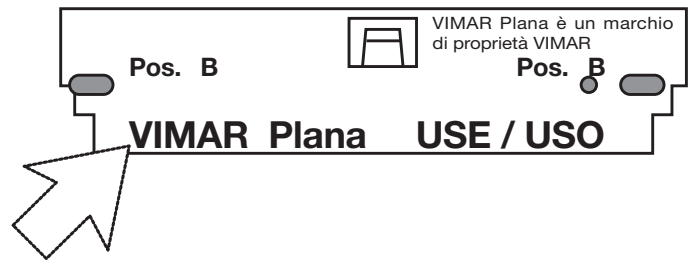

ASSEMBLING THE ADAPTORS

1
Take the pair of adaptors for the electrical series in use. Read the letter (for example, B) that indicates the position for inserting the centring devices (R) and (L).

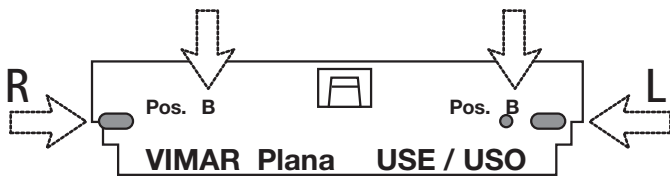

2
Take the CMT800 and align the adaptor so that the centring devices correspond to the holes indicated by the letter (in this example, B).

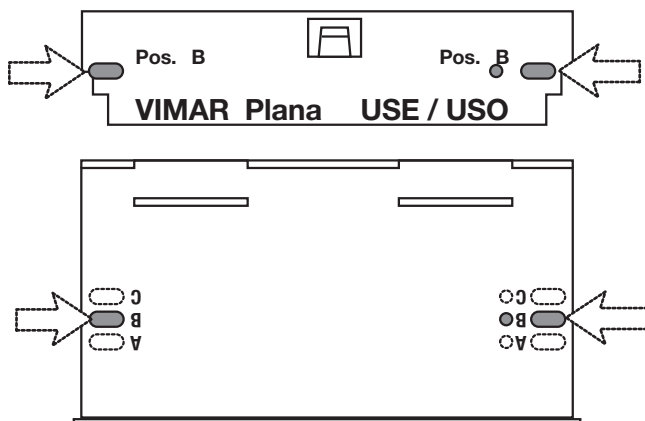

3
Turn over the adaptor and insert the centring device in the CMT800. Repeat the operation on the other side of the CMT800.

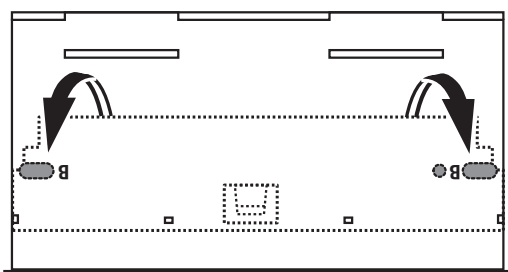

4
Insert the CMT800 with the adaptors in the 3 module switch plate support for the electrical series that is used and complete the installation.

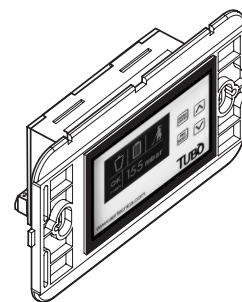
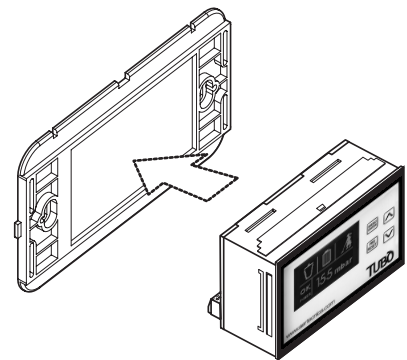

COMPATIBLE ELECTRICAL SWITCH PLATES

BTICINO	Axolute
BTICINO	Living
BTICINO	Light

VIMAR	Idea
VIMAR	Plana
VIMAR	Eikon

GEWISS	Chorus Lux
GEWISS	Chorus One
GEWISS	Chorus Art

WAHL DES ADAPTERMODELLS

Für den Einbau des CMT800 ist die Abdeckrahmenhalterung 3 Module der verwendeten elektrischen Serie notwendig. Auf jedem Adapter ist der Name der elektrischen Serie eingestanzt. Wählen Sie das der verwendeten elektrischen Serie entsprechende Adapterpaar.

BEISPIEL *Elektrische Serie* **VIMAR PLANA**
 Abdeckrahmenhalterung **VIMAR PLANA**
 Adapter **VIMAR PLANA**

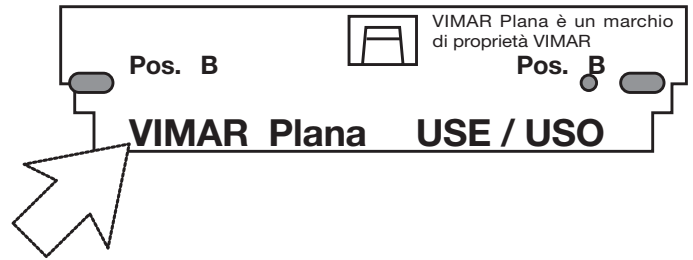

EINBAU DER ADAPTER

1
Das Adapterpaar der verwendeten elektrischen Serie aufnehmen. Den Buchstaben (in diesem Beispiel B) ablesen, der die Einsetzposition der Zentrierer (R) und (L) anzeigt.



2
Den CMT800 aufnehmen und den Adapter so ausrichten, dass sich die Zentrierer auf der Höhe der vom Buchstaben (in diesem Beispiel B) angezeigten Bohröffnungen befindet.

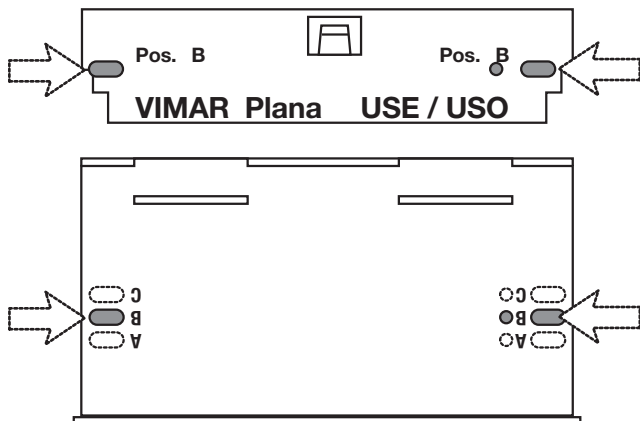

3
Den Adapter abkippen und die Zentrierer im CMT800 einsetzen. Den Vorgang auf der anderen Seite des CMT800 wiederholen.

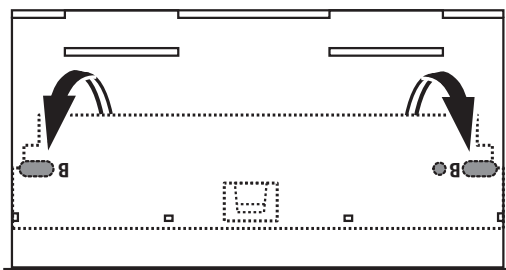

4
Den CMT800 mit den Adaptern in der Abdeckrahmenhalterung 3 Module der verwendeten elektrischen Serie einsetzen und den Einbau abschließen.

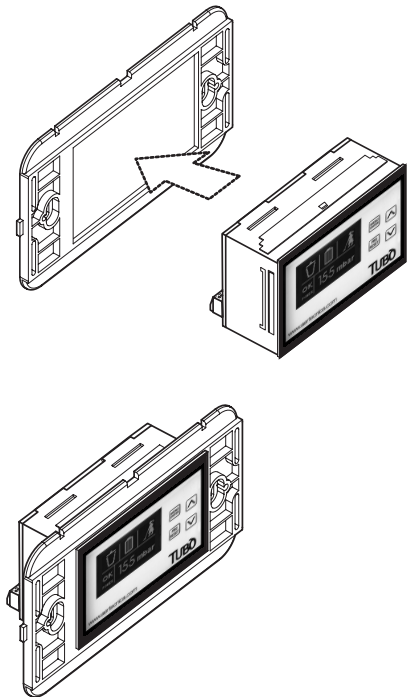

KOMPATIBLE ABDECKRAHMENHALTERUNGEN	
BTICINO	Axolute
BTICINO	Living
BTICINO	Light
VIMAR	Idea
VIMAR	Plana
VIMAR	Eikon
GEWISS	Chorus Lux
GEWISS	Chorus One
GEWISS	Chorus Art

CHOIX DU MODÈLE DES ADAPTATEURS

Pour l'installation du CMT800 est nécessaire le support de plaque à 3 modules de la série électrique utilisée. Sur chaque adaptateur est imprimé le nom de la série électrique. Choisir la paire d'adaptateurs correspondant à la série électrique utilisée.

EXEMPLE Série électrique **VIMAR PLANA**
Support de plaque **VIMAR PLANA**
Adaptateurs **VIMAR PLANA**

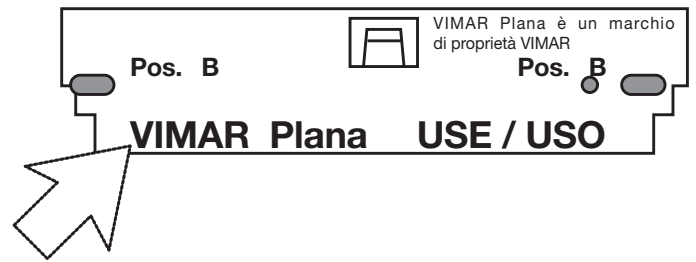

MONTAGE DES ADAPTATEURS

1
Prendre la paire d'adaptateurs de la série électrique utilisée. Lire la lettre (dans cet exemple le B) qui indique la position d'insertion des centres (R) et (L).



2
Prendre le CMT800 et aligner l'adaptateur de manière à ce que les centres soient à la hauteur des trous indiqués par la lettre (dans cet exemple le B).

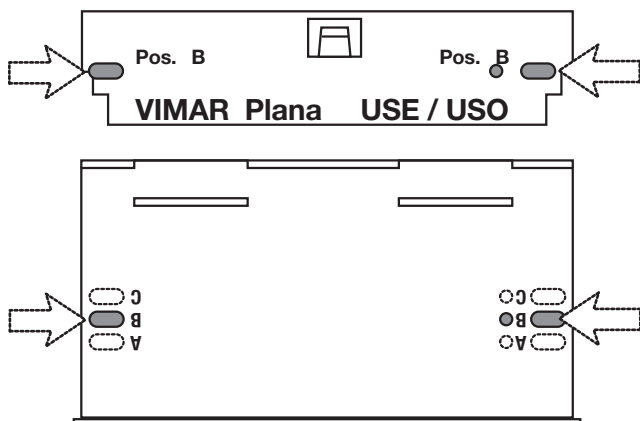

3
Retourner l'adaptateur et insérer les centres dans le CMT800. Répéter l'opération sur l'autre côté du CMT800.

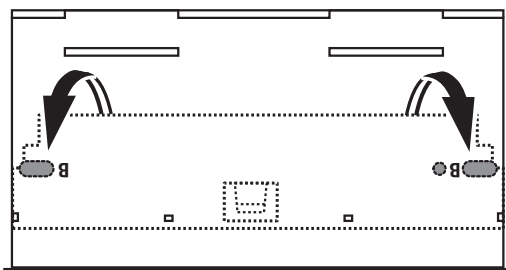

4
Insérer le CMT800 avec les adaptateurs dans le support de plaque à 3 modules de la série électrique utilisée et compléter l'installation.

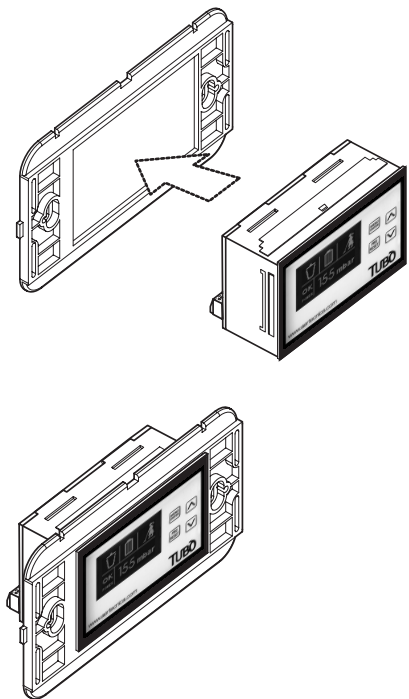

PLAQUES ÉLECTRIQUES COMPATIBLES

BTICINO	Axolute
BTICINO	Living
BTICINO	Light
VIMAR	Idea
VIMAR	Plana
VIMAR	Eikon
GEWISS	Chorus Lux
GEWISS	Chorus One
GEWISS	Chorus Art

ELECCIÓN DEL MODELO DE LOS ADAPTADORES

Para instalar el CMT800 se necesita el soporte de placa de 3 módulos de la serie eléctrica utilizada. Cada adaptador lleva impreso el nombre de la serie eléctrica. Elija el par de adaptadores correspondiente a la serie eléctrica utilizada.

EJEMPLO *Serie eléctrica* **VIMAR PLANA**
Soporte de placa **VIMAR PLANA**
Adaptadores **VIMAR PLANA**

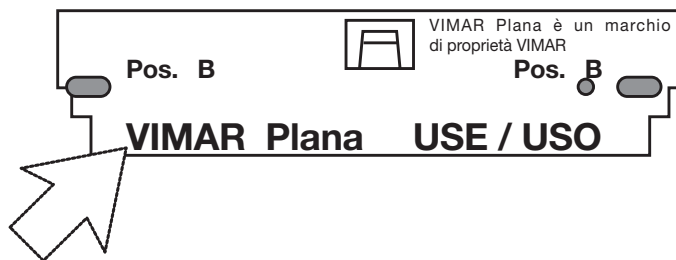

MONTAJE DE LOS ADAPTADORES

1
Tome el par de adaptadores de la serie eléctrica utilizada. Observe la letra (en este ejemplo la B) que indica la posición de introducción de los centradores (R) y (L).



2
Tome el CMT800 y alinee el adaptador de manera que los centradores coincidan con los orificios indicados por la letra (en este ejemplo la B).

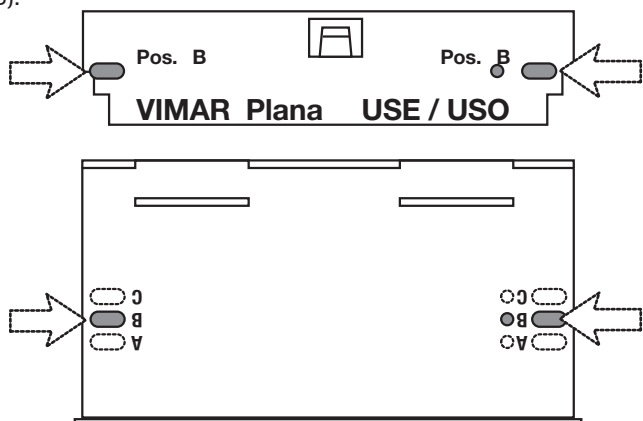

3
Ponga el adaptador en horizontal e introduzca los centradores en el CMT800.

Repita esta operación en el otro lado del CMT800.

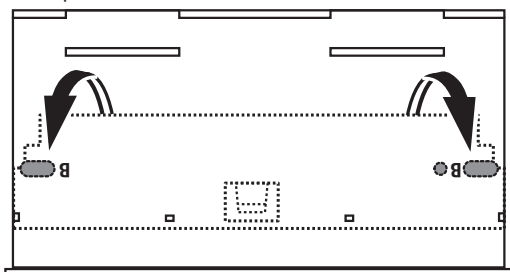

4
Introduzca el CMT800 con los adaptadores en el soporte de placa de 3 módulos de la serie eléctrica utilizada y complete la instalación.

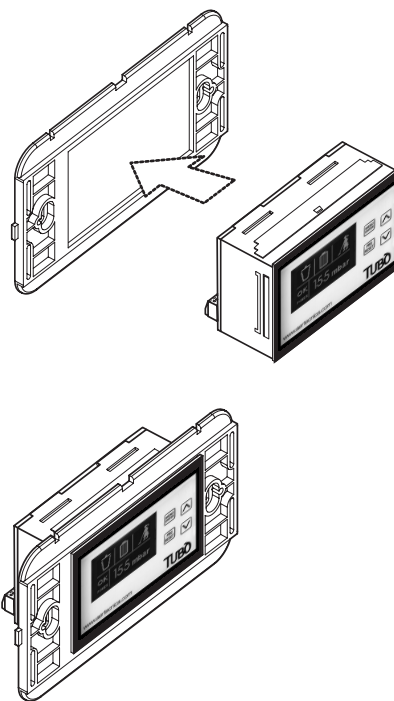

PLACAS ELÉCTRICAS COMPATIBLES

BTICINO Axolute
BTICINO Living
BTICINO Light

VIMAR Idea
VIMAR Plana
VIMAR Eikon

GEWISS Chorus Lux
GEWISS Chorus One
GEWISS Chorus Art

ESCOLHA DO MODELO DOS ADAPTADORES

Para a instalação do CMT800 é necessário o suporte placa 3 módulos da série eléctrica utilizada. Em cada adaptador está imprimido o nome da série eléctrica. Escolha o par de adaptadores correspondente à série eléctrica utilizada.

EXEMPLO *Série eléctrica* **VIMAR PLANA**
Suporte placa **VIMAR PLANA**
Adaptadores **VIMAR PLANA**

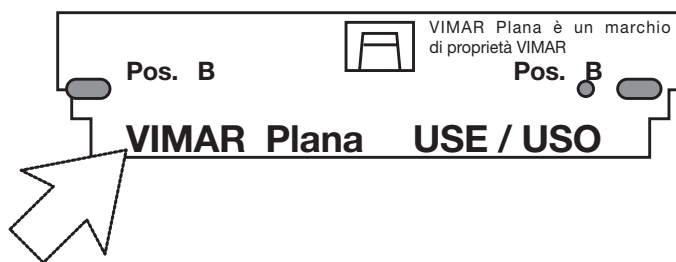

MONTAGEM DOS ADAPTADORES

1
Pegue no par de adaptadores da série eléctrica usada actualmente. Leia a letra (neste exemplo a B) que indica a posição de introdução dos centradores (R) e (L).



2
Pegue no CMT800 e alinhe o adaptador de modo que os centradores fiquem ao nível dos furos indicados pela letra (neste exemplo a B).

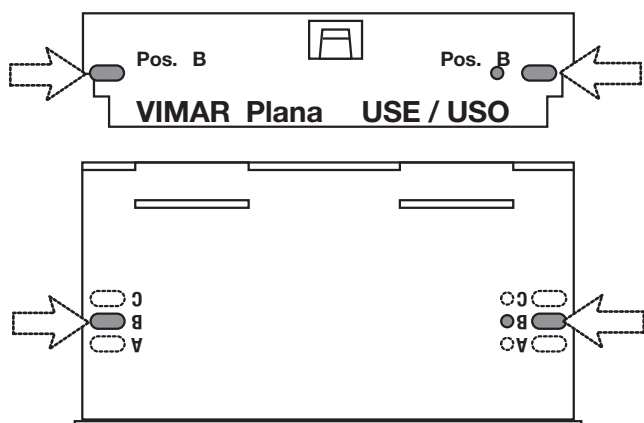

3
Vire o adaptador e insira os centradores no CMT800. Repita a operação do outro lado do CMT800.

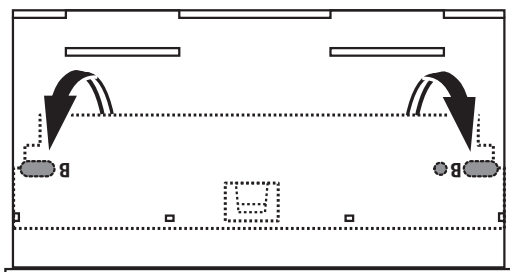

4
Insira o CMT800 com os adaptadores no suporte placa 3 módulos da série eléctrica utilizada e complete a instalação.

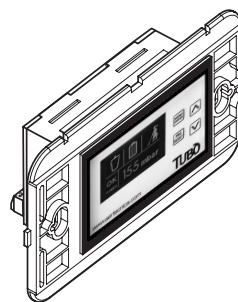
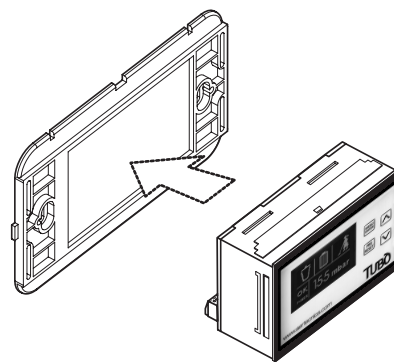

PLACAS ELÉCTRICAS COMPATÍVEIS

BTICINO Axolute
BTICINO Living
BTICINO Light

VIMAR Idea
VIMAR Plana
VIMAR Eikon

GEWISS Chorus Lux
GEWISS Chorus One
GEWISS Chorus Art